

CENTRO

DIREZIONALE

PIAZZA SALERNO

POSTEGGI FIERA

POSTEGGI FIERA

AREA MERCATO CONTADINO

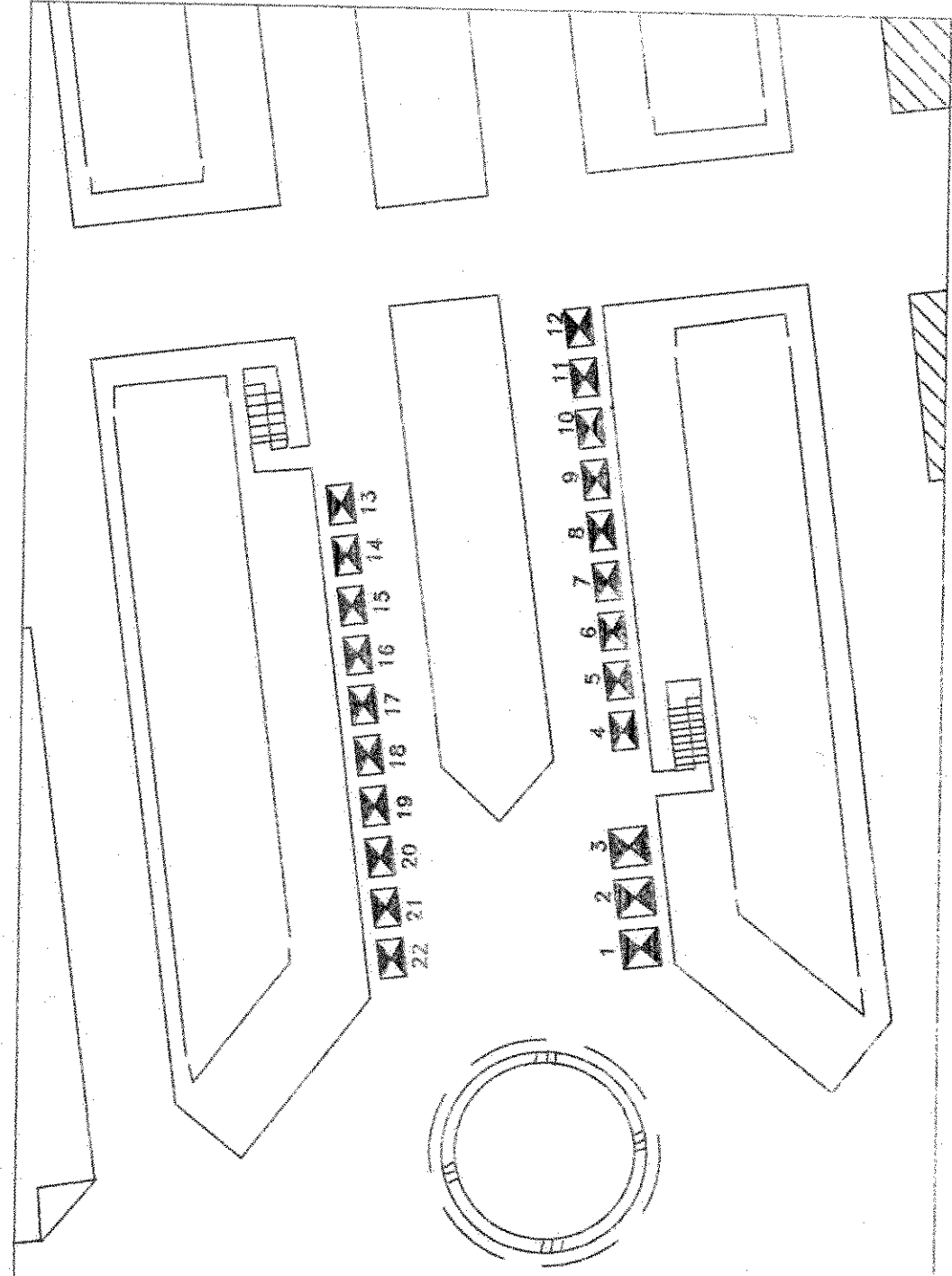

Comune di Napoli
IV MUNICIPALITA'



MERCATO DI NATALE 2011

CENTRO DIREZIONALE (1)
Prossimità Gruppo Catopano

TAV. 8

Esposizione
Fino 15/10

Legenda

 S. 11. 5
 S. 11. 10
 S. 11. 15

P.zza/Teat. Raffaele Bonanni
 I.P.T. Ciro Miranda
 I.T. Antonio Palotta
 L.L. Giuseppe Balino

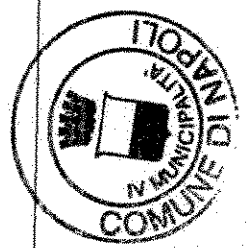

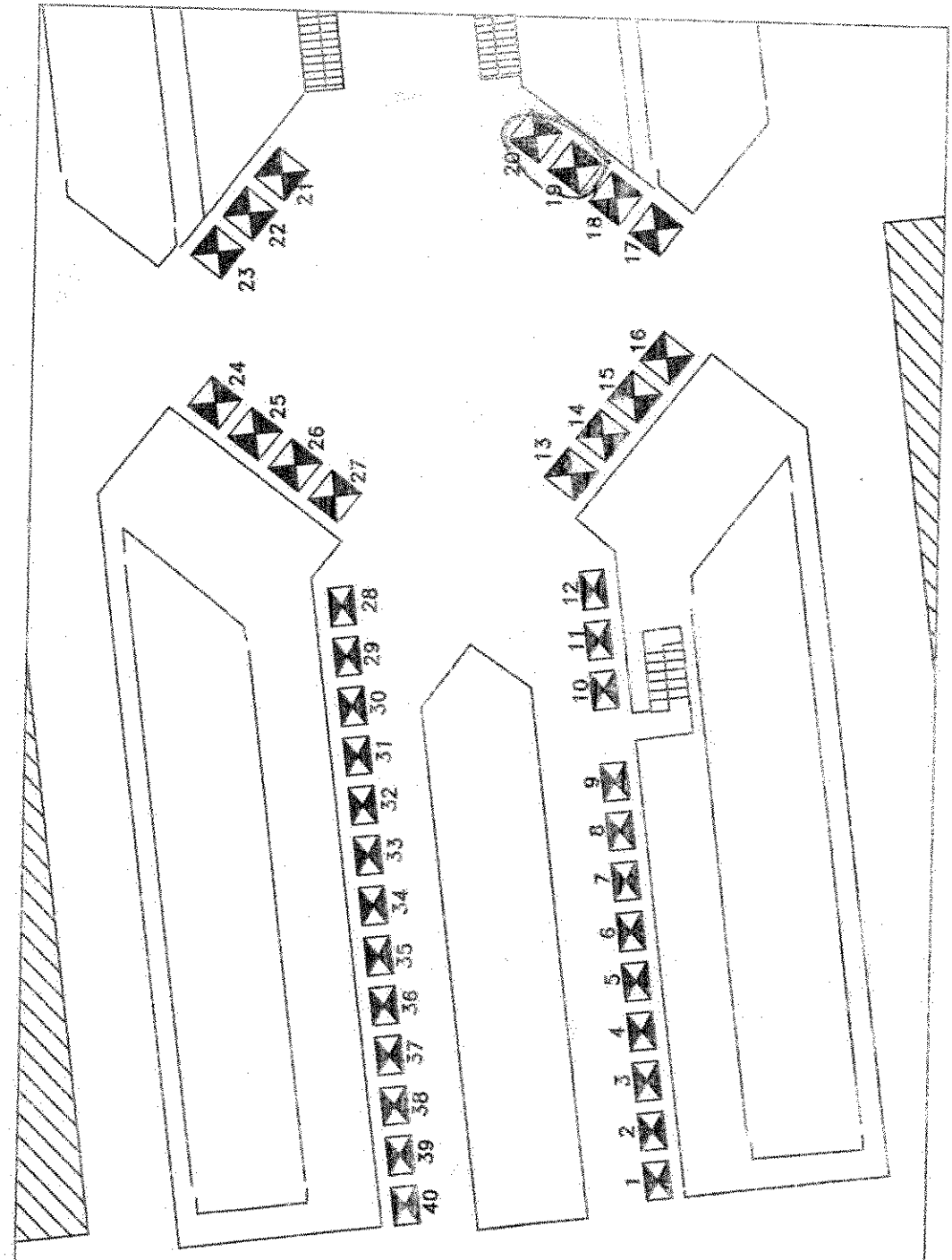

Comune di Napoli
IV MUNICIPALITÀ

MERCATO DI NATALE 2011

CENTRO DIREZIONALE (2)
Prossimità Edificio TIM

TAV. 8

Esclusivamente
Banco L. 2000

Legenda

	ALBERGO - N. 10
	ALBERGO - N. 20
	ALBERGO

Font. Terra, Raffaele Romanelli
L.R.T. Ciro Miranda
L.T. Antonio Palotta
L.A. Giuseppe Balmo

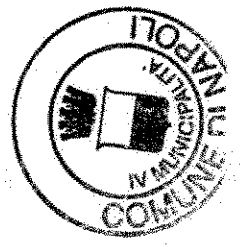

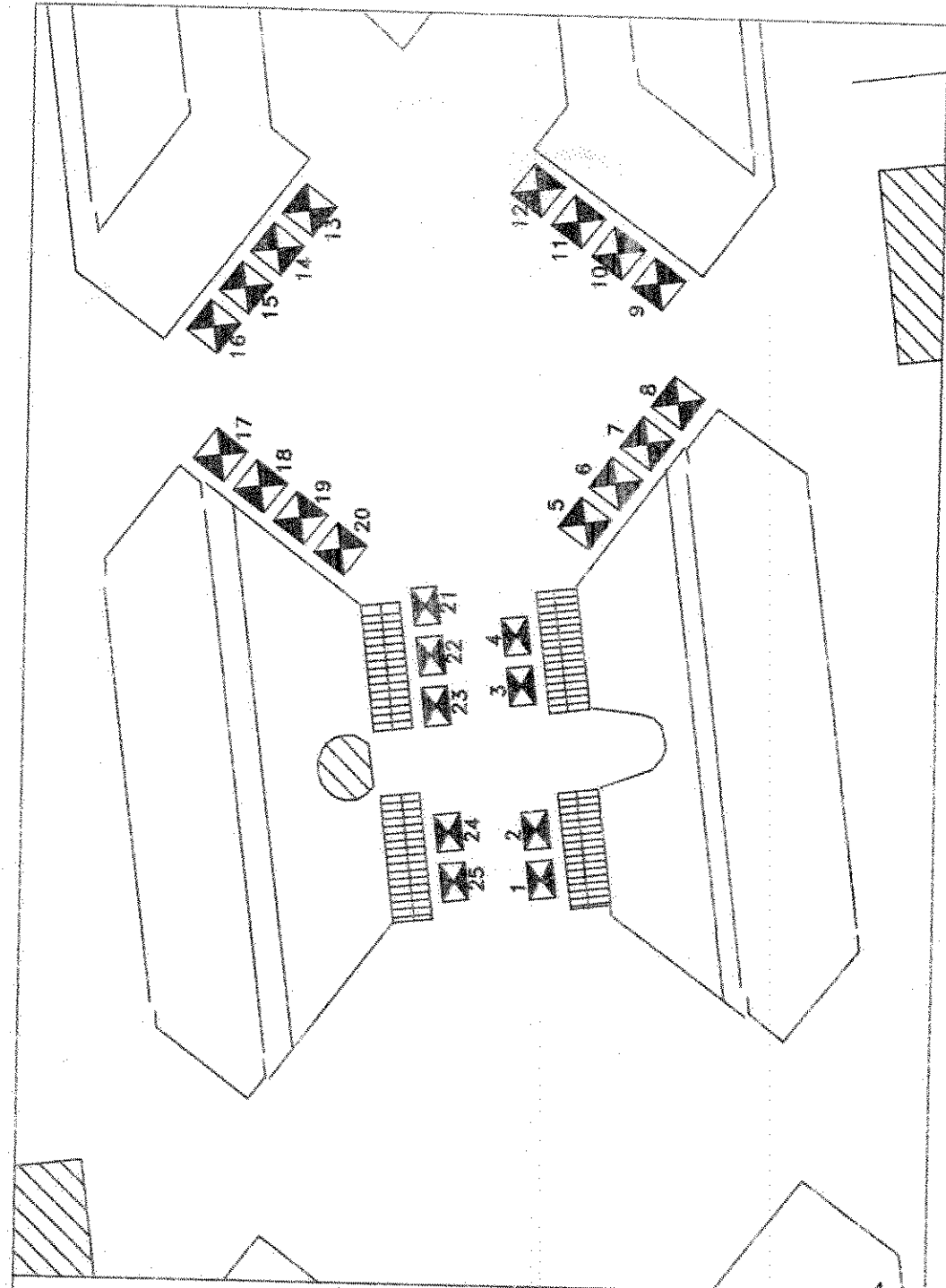

Comune di Napoli
IV MUNICIPALETÀ

MERCATO DI NATALE 2011

CENTRO DIREZIONALE (8)
Prossimità "Bar Franco"

TAV. 4

Per Segreteria Mercato
Natale 2011

Legenda



 Stalls 1-10 - N. 10

 Stalls 11-20 - N. 20

 Stalls 21-25

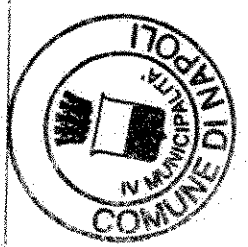
P.zza Fern. Raffaele Esposito
 I.P.T. Cleo Miranda
 I.T. Antonio Palicella
 I.A. Giuseppe Balino

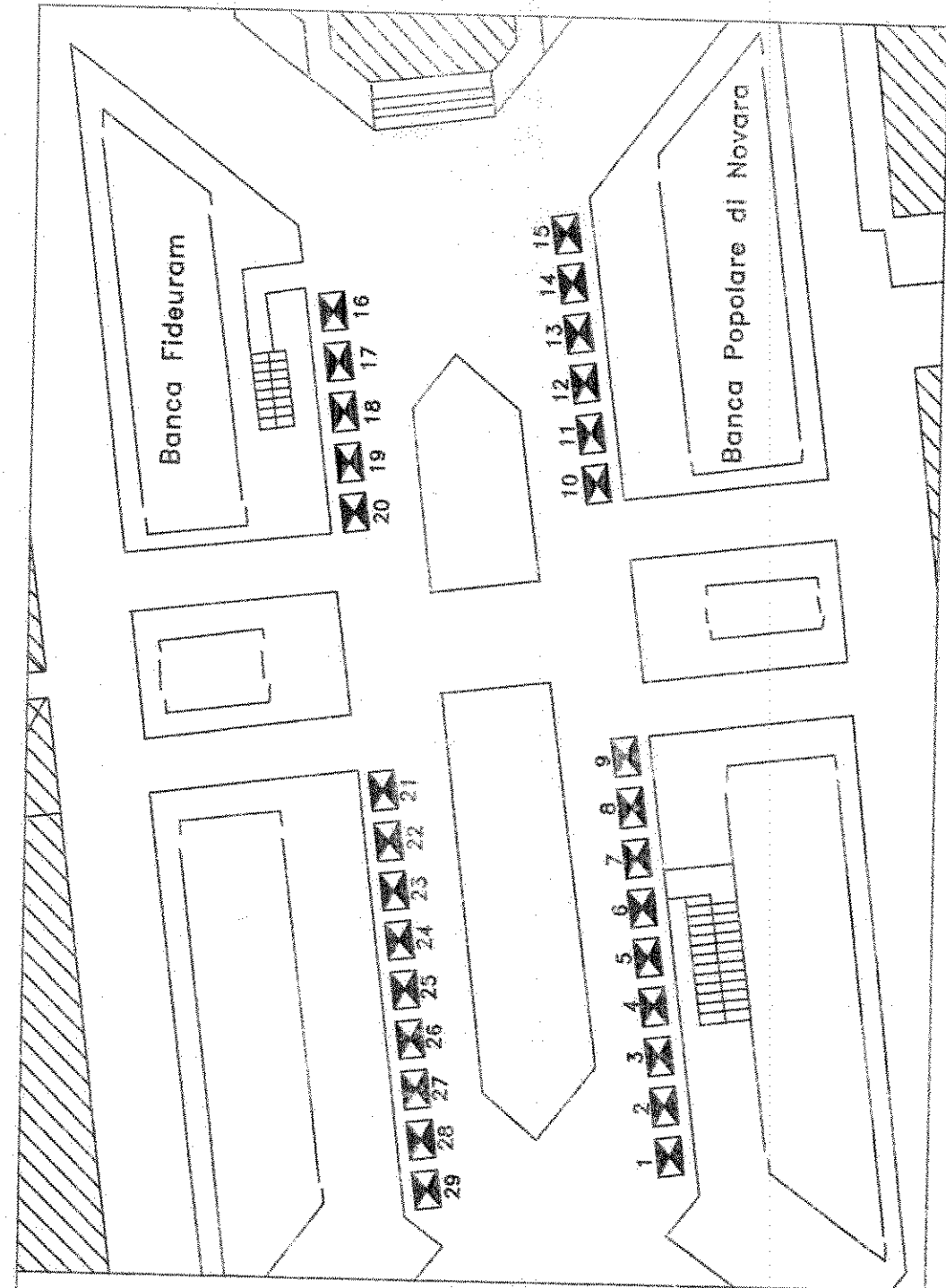





Comune di Napoli
IV MUNICIPALITA'

MERCATO DI NATALE 2011
CENTRO DIREZIONALE (4)
Isola D/2
TAV. 6

Assegnato alla
Pubblica Amministrazione

Legenda
 STALLI
 ENTRATA - U. 50
 USCITA

Funzione, Raffaele Romanelli
 E.T. Cleo Miranda
 E.T. Antonio Pallotta
 E.A. Giuseppe Reano

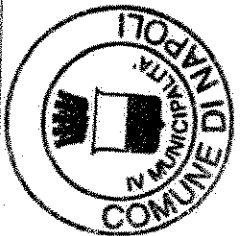

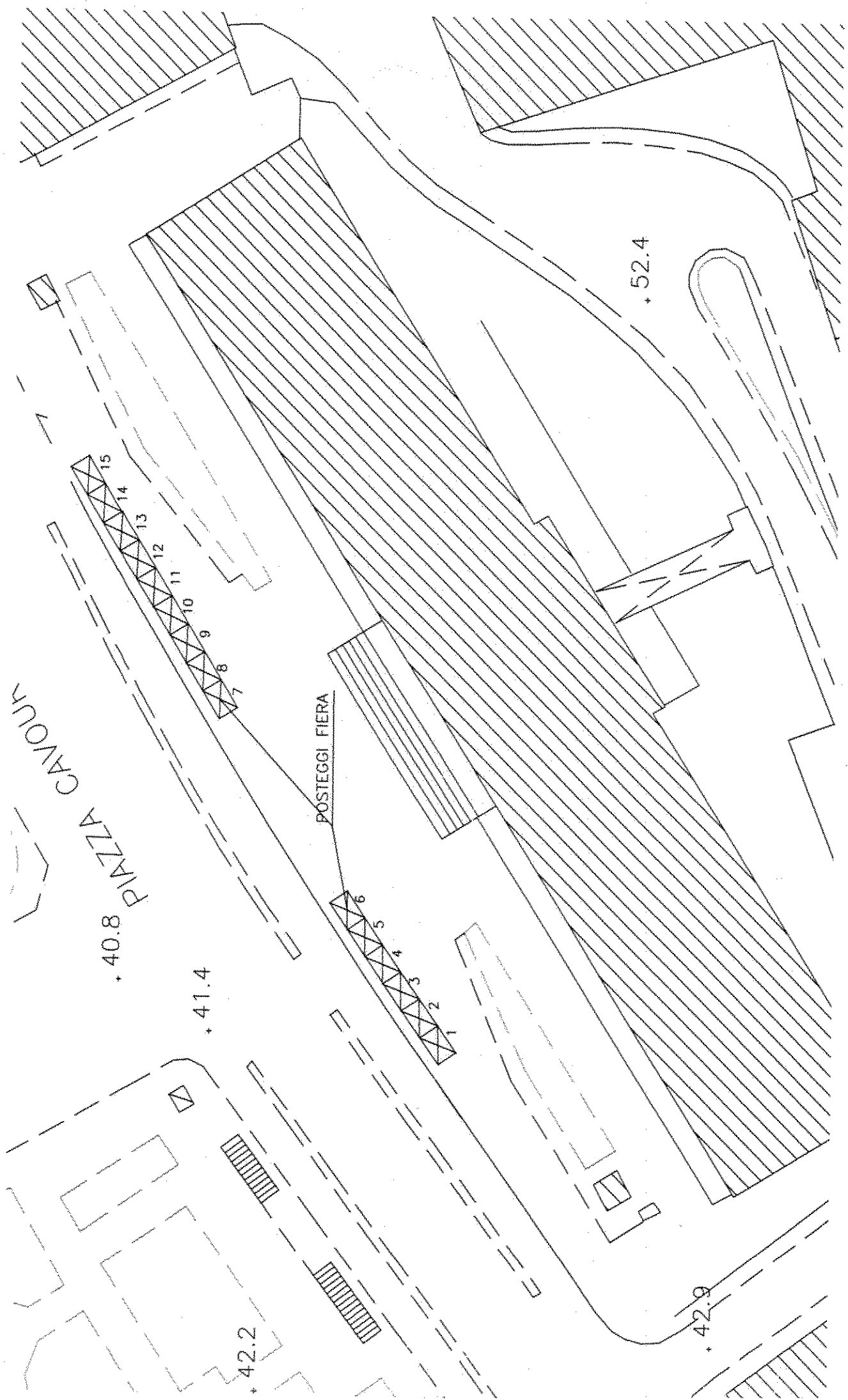

PIAZZA CANOUN

POSTEGGI FIERA

+ 40.8

+ 41.4

+ 42.2

+ 52.4

+ 42.9

15

14

13

12

11

10

9

8

6

5

4

3

2

1

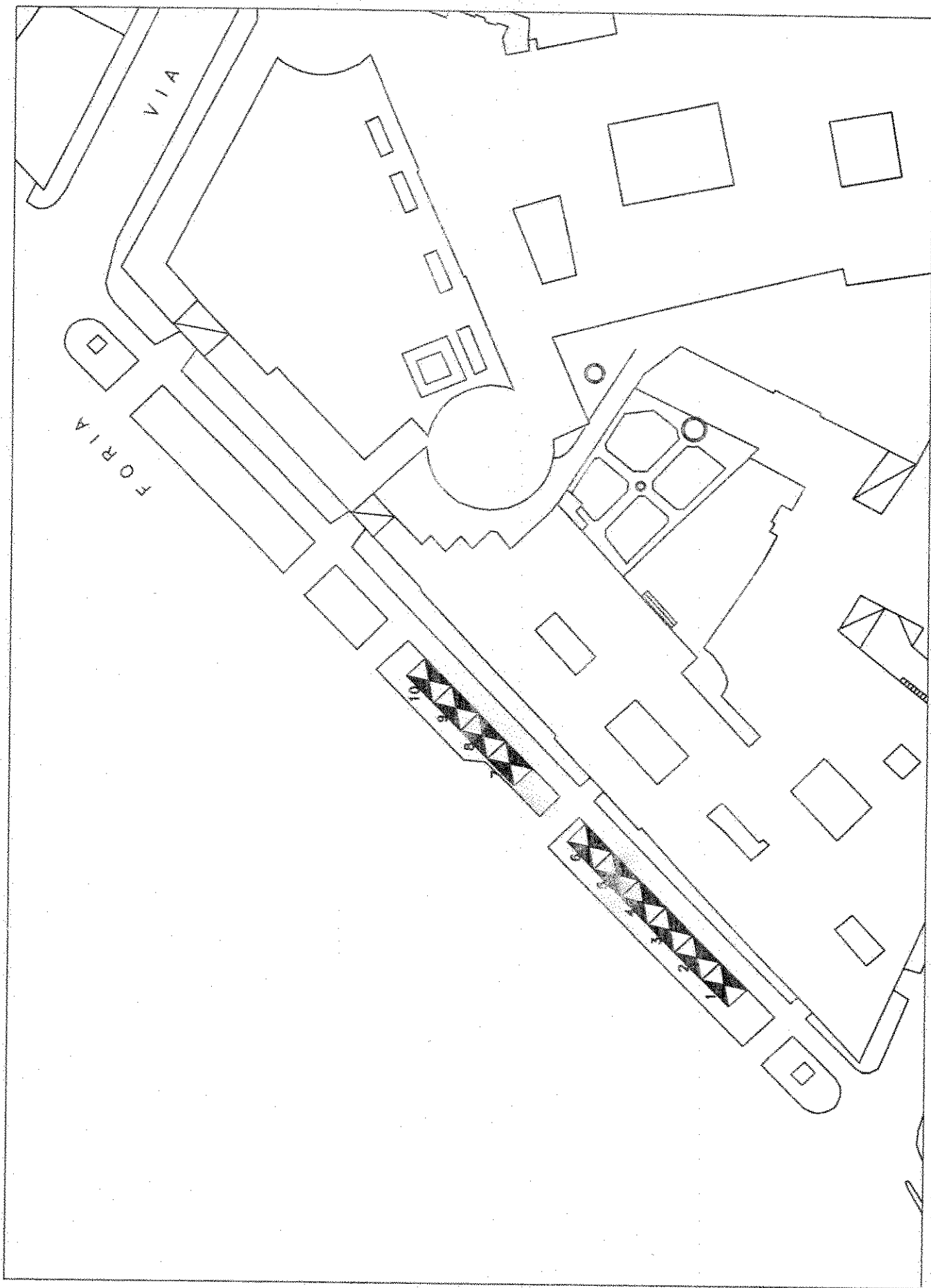

VIA FORIA

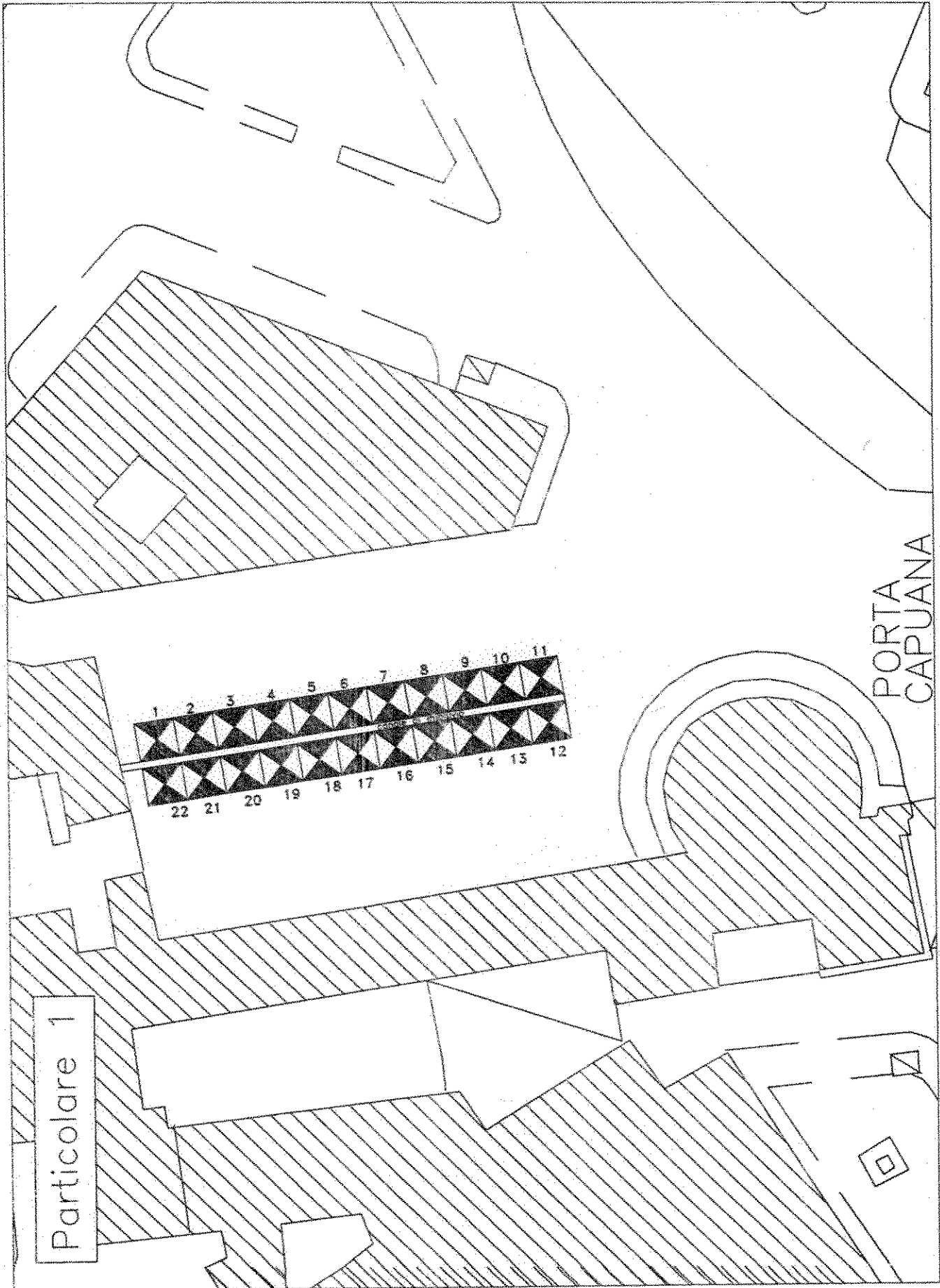

PORTA
CAPUANA

Particolare 1

1 2 3 4 5 6 7 8 9 10 11
22 21 20 19 18 17 16 15 14 13 12

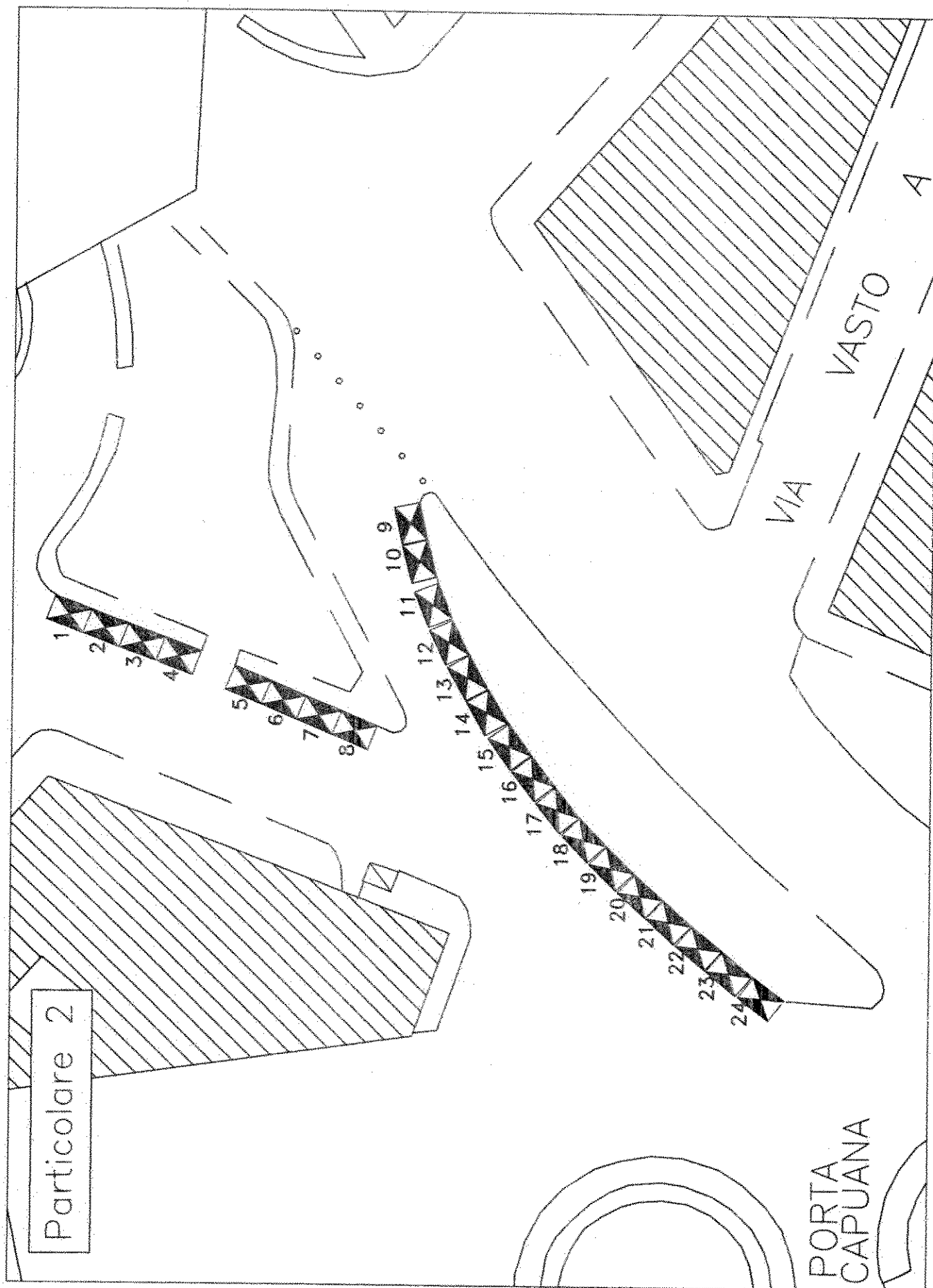

Particolare 2

PORTA
CAPUANA

VIA
VASTO

